

# 1000 BRICKELL PLZ 2601 MIAMI FL 33131

<https://www.cays.com>

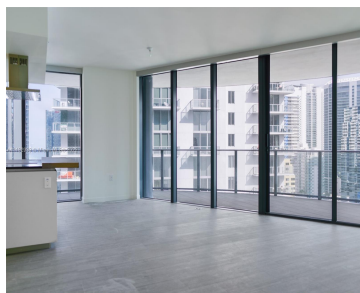
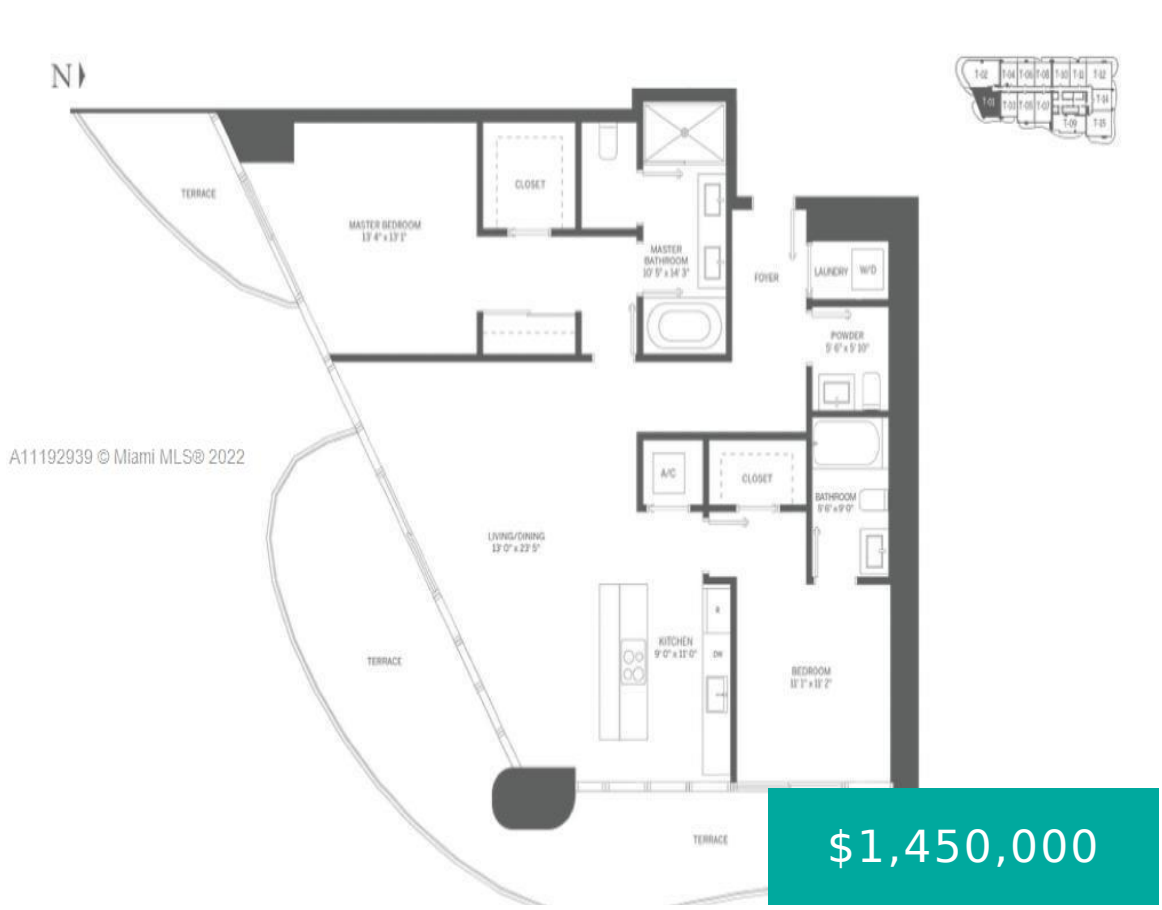

- 2 beds
- 3 baths
- Condominium
- Residential
- Active
- 1286 sq ft

## Basics

**Bathrooms Half:** 1  
**Lot Size Units:** Square Feet  
**Type:** Condominium  
**Bedrooms:** 2 beds  
**Area:** 1286 sq ft

**Bathrooms Full:** 2  
**Category:** Residential  
**Status:** Active  
**Bathrooms:** 3 baths  
**Year built:** 2019



---

## Property details

**Direction Faces:** West

**Subdivision Name:** Brickell Flatiron

**Parcel Number:** 01-41-00-000-2601

**Possession:** Closing & Funding, Negotiable

---

## Property Features

**Interior Features:** Bedroom on Main Level

**Pool Features:** Heated

**Parking Features:** One Space, Valet

**Appliances:** Other

**Architectural Style:** High Rise

**Association Amenities:** Billiard Room, Business Center, Clubhouse, Fitness Center, Playground, Pool, Sauna, Spa/Hot Tub

**Cooling:** Central Air

**Cooling Y/N:** 1

**Covered Spaces:** 2

**Flooring:** Ceramic Tile

**Furnished:** Unfurnished

**Garage Spaces:** 2

**Garage Y/N:** 1

**Heating:** Central

**Heating Y/N:** 1

**New Construction Y/N:** 1

**Pets Allowed:** Conditional, Yes

**View:** City

**Entry Level:** 26

**Entry Location:** 26

**Property Attached Y/N:** 1

**Stories Total:** 64

---

## Rooms & Units Description

**Unit Number:** 2601

---

## Location Details

**County Or Parish:** Miami-Dade County



---

## Fees & Taxes

**Tax Annual Amount:** 12840

**Tax Year:** 2021

**Tax Legal Description:** Brickell Flatiron condo unit 2601

**Association Fee Frequency:**  
Monthly

**Association Fee Includes:** Other

---

## Miscellaneous

**Development Status:** New Construction

**Public Survey  
Township:** 1

**Syndication Remarks:** .

**Year Built  
Details:** Resale

**Virtual Tour URL:**

<https://www.propertypanorama.com/instaview/mia/A11192939>

---

## Courtesy of

**Office Name:** IPM Worldwide Properties

