

1600 NE 1ST AVE 2420 MIAMI FL 33132

https://www.cays.com

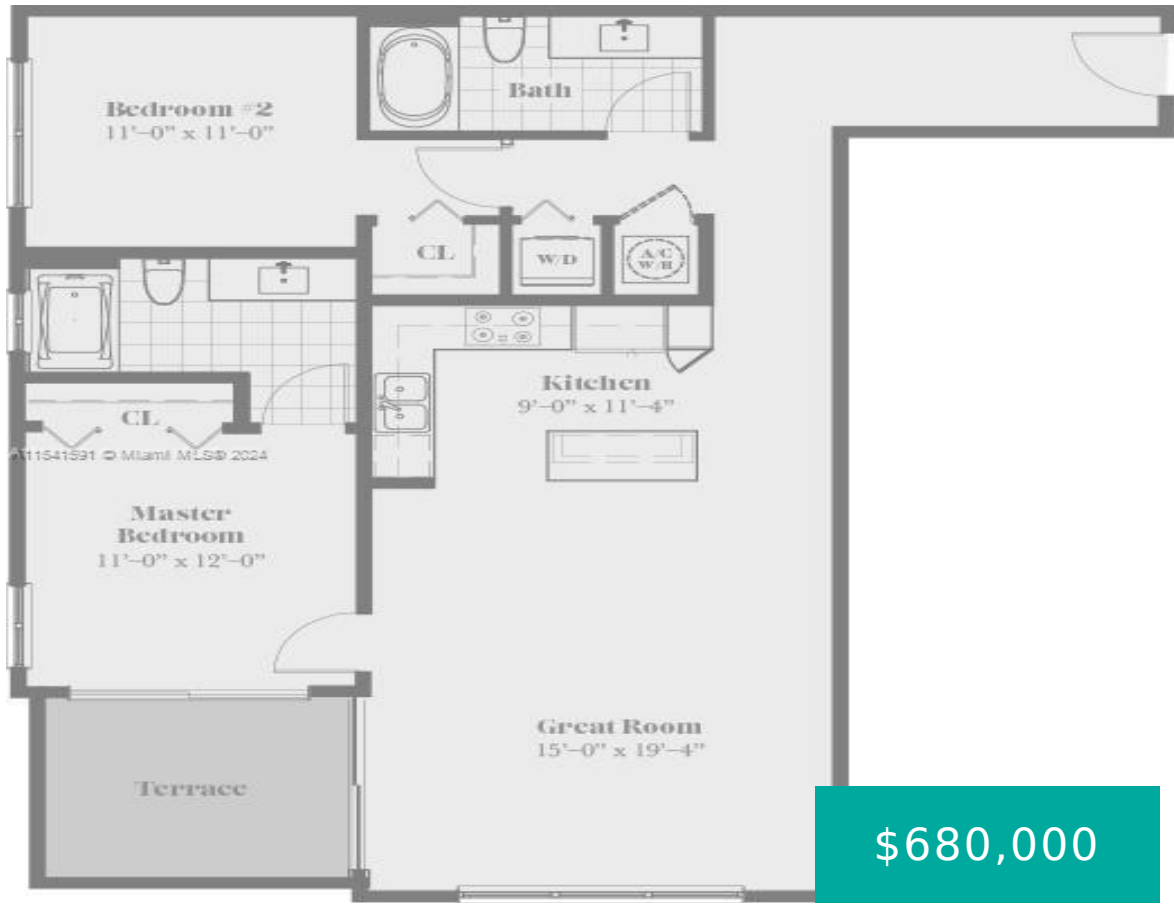

\$680,000



With floor-to-ceiling windows and blinds and a highly efficient floor plan, it features a split design with an open kitchen equipped with top-of-the-line stainless steel appliances, a combination of bright European design, kitchen cabinets with quartz countertops, and a unique offering of additional storage room on the same floor. It is in an excellent location [...]

- 2 beds
- 2 baths
- Condominium
- Residential
- Active
- 1009 sq ft

Basics

Bathrooms Full: 2
Category: Residential
Status: Active
Bathrooms: 2 baths
Year built: 2018

Lot Size Units: Square Feet
Type: Condominium
Bedrooms: 2 beds
Area: 1009 sq ft



Property details

Direction Faces: Northeast

Parcel Number: 01-31-36-096-5000

Subdivision Name: CANVAS CONDO

Possession: Close Of Escrow

Property Features

Exterior Features: Balcony

Waterfront Features: Bay Front

Parking Features: Attached,Covered,Garage,Valet

Appliances: Dryer,Dishwasher,Electric Range,Electric Water Heater,Disposal,Microwave,Refrigerator,Self Cleaning Oven,Washer

Association Amenities: Elevator(s),Fitness Center,Other,Sauna

Cooling: Central Air

Covered Spaces: 2

Furnished: Unfurnished

Garage Y/N: 1

Heating Y/N: 1

View: Bay

Entry Level: 18

Patio and Porch Features: Balcony,Open

Attached Garage Y/N: 1

Utilities: Cable Available

Interior Features: Built-in Features,Eat-in Kitchen,Elevator,Bar

Window Features: Blinds,Impact Glass

Security Features: Elevator Secured,Key Card Entry,Lobby Secured,Fire Sprinkler System

Architectural Style: High Rise

Construction Materials: Block

Cooling Y/N: 1

Flooring: Tile

Garage Spaces: 2

Heating: Electric

Pets Allowed: Size Limit,Yes

View Y/N: 1

Entry Location: 18

Property Attached Y/N: 1

Stories Total: 36

Rooms & Units Description

Unit Number: 2420



Location Details

County Or Parish: Miami-Dade County

Fees & Taxes

Tax Annual Amount: 9673

Tax Year: 2023

Tax Legal Description: CANVAS CONDO
UNIT 2420 UNDIV 0.2275% INT IN COMMON
ELEMENTS OFF REC 31271-1538

Association Fee: 996

Association Fee Frequency: Monthly

Association Fee Includes: Association
Management,Common Areas,Hot
Water,Internet,Recreation Facilities

Miscellaneous

Public Survey Township: 1

**Public
Survey
Section:** 36

Syndication Remarks: Charming apartment available for sale & lease! Besides features blinds, shades, and an extra storage room on the same floor. Don't miss out!"

**Year Built
Details:**
Effective Year
Built

Virtual Tour URL:

<https://www.propertypanorama.com/instaview/mia/A11541591>

Courtesy of

Office Name: Related ISG Realty, LLC.

