

# 2101 BRICKELL AVE 303 MIAMI FL 33129

<https://www.cays.com>

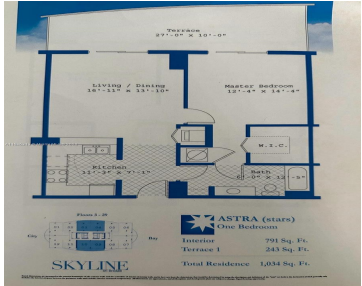

Enjoy resort-style living in South Brickell at the Skyline. This light and bright 1 bed/1 bath 791 sq ft unit with an extra large 243 sq ft balcony totaling 1,034 sq ft of space. Features 2 parking spaces and 2 storage units (one with AC), a spacious walk-in closet, newer Bosh A/C unit, GE dishwasher, [...]

- 1 bed
- 1 bath
- Condominium
- Residential
- Active
- 791 sq ft

## Basics

**Bathrooms Full:** 1  
**Category:** Residential  
**Status:** Active  
**Bathrooms:** 1 bath  
**Year built:** 2004

**Lot Size Units:** Square Feet  
**Type:** Condominium  
**Bedrooms:** 1 bed  
**Area:** 791 sq ft



---

## Property details

**Builder Model:** 03B line

**Total Building Area:** 791

**Direction Faces:** South

**Subdivision Name:** SKYLINE ON BRICKELL CONDO

**Parcel Number:** 01-41-39-084-0650

**Possession:** Closing & Funding, Close Of Escrow

**Property Condition:** Updated/Remodeled

---

## Property Features



**Building Features:** Exterior Lighting

**Interior Features:** Breakfast Bar,Family/Dining Room,Living/Dining Room,Main Living Area Entry Level,Walk-In Closet(s)

**Waterfront Features:** Bay Front,Intracoastal Access,Ocean Access,Seawall

**Pool Features:** Association

**Security Features:** Closed Circuit Camera(s),Secured Garage/Parking,Key Card Entry,Security Guard,Fire Sprinkler System,Smoke Detector(s)

**Architectural Style:** High Rise

**Construction Materials:** Block

**Cooling Y/N:** 1

**Flooring:** Marble

**Garage Spaces:** 2

**Heating:** None

**View:** Bay,Garden,Intercoastal

**Entry Level:** 3

**Patio and Porch Features:** Balcony,Open

**Waterfront Y/N:** 1

**Stories Total:** 35

**Exterior Features:** Balcony,Barbecue,Security/High Impact Doors,Tennis Court(s)

**Accessibility Features:** Accessible Hallway(s)

**Window Features:** Blinds,Impact Glass

**Parking Features:** Attached,Electric Vehicle Charging Station(s),Garage,Two or More Spaces

**Appliances:** Dryer,Dishwasher,Electric Range,Electric Water Heater,Disposal,Ice Maker,Microwave,Refrigerator,Washer

**Association Amenities:** Bike Storage,Clubhouse,Elevator(s),Fitness Center,Barbecue,Picnic Area,Playground,Pool,Sauna,Spa/Hot Tub,Tennis Court(s),Trash

**Cooling:** Central Air,Zoned

**Covered Spaces:** 2

**Furnished:** Negotiable

**Garage Y/N:** 1

**Pets Allowed:** Conditional,Yes

**View Y/N:** 1

**Entry Location:** 3

**Property Attached Y/N:** 1

**Attached Garage Y/N:** 1

---

## Rooms & Units Description

**Unit Number:** 303

**Number of Units in the Community:** 360

---

## Location Details



County Or Parish: Miami-Dade County

---

## Fees & Taxes

**Tax Annual Amount:** 5660

**Tax Year:** 2022

**Tax Legal Description:**

SKYLINE ON BRICKELL CONDO  
UNIT 303 UNDIV 0.20873 %  
INT IN COMMON ELEMENTS  
OFF REC 22848-4086 COC  
22921-0454 11 2004 1

**Association Fee:** 950

**Association Fee Frequency:**  
Monthly

**Association Fee Includes:** Association  
Management,Amenities,Common  
Areas,Insurance,Legal/Accounting,Maintenance  
Grounds,Maintenance Structure,Pool(s),Trash,Water

---

## Miscellaneous

**Public Survey  
Section:** 39

**Syndication Remarks:** Unit 303 is a 1bed 1 bath waterfront condo offering  
2 parking spaces & 2 storage units. Unit has been partially remodeled  
between 2023- 2024.

**Year Built  
Details:** New  
Construction

**Virtual Tour URL:**  
<https://www.propertypanorama.com/instaview/mia/A11526313>

---

## Courtesy of

**Office Name:** Property Hub 1, LLC.

