

335 S BISCAYNE BLVD 1002 MIAMI FL 33131

<https://www.cays.com>

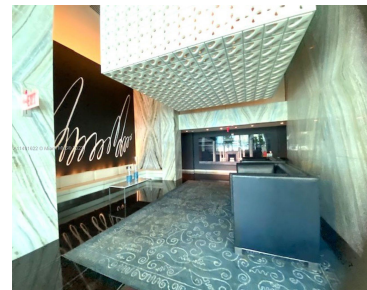

\$430,000

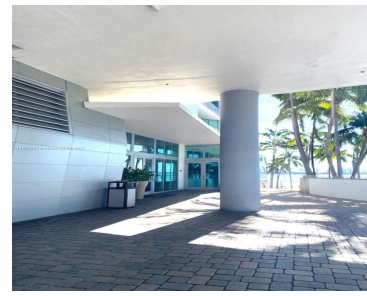

Beautiful 1/1 unit in One Miami East with views of Biscayne Bay and the Brickell skyline. Enjoy 5-star amenities including lobby with 24 hour security, gym, valet parking, 2 swimming pools, solarium, jacuzzi, sauna, lounge room and more. Private parking is on the same floor as unit. New A/C. Washer and dryer inside unit. Walking [...]

- 1 bed
- 1 bath
- Condominium
- Residential
- Active
- 846 sq ft

Basics

Bathrooms Full: 1

Category: Residential

Status: Active

Bathrooms: 1 bath

Year built: 2005

Lot Size Units: Square Feet

Type: Condominium

Bedrooms: 1 bed

Area: 846 sq ft



Property details

Total Building Area: 846

Parcel Number: 01-42-06-065-0680

Subdivision Name: ONE MIAMI EAST CONDO

Possession: Closing & Funding

Property Features

Exterior Features: Security/High Impact Doors

Laundry Features: Washer Hookup,Dryer Hookup

Window Features: Blinds,Impact Glass

Security Features: Complex Fenced,Door Man,Secured Garage/Parking,Key Card Entry,Smoke Detector(s)

Architectural Style: High Rise

Construction Materials: Block

Cooling Y/N: 1

Flooring: Carpet,Ceramic Tile

Garage Y/N: 1

Heating Y/N: 1

View: Bay

Entry Level: 10

Property Attached Y/N: 1

Stories Total: 45

Interior Features: Bedroom on Main Level,First Floor Entry

Waterfront Features: Bay Front,Intracoastal Access

Parking Features: One Space

Appliances: Dishwasher,Electric Range,Electric Water Heater,Disposal,Microwave

Association Amenities: Business Center,Elevator(s),Fitness Center

Cooling: Central Air

Covered Spaces: 1

Garage Spaces: 1

Heating: Central

Pets Allowed: Conditional,Yes

View Y/N: 1

Entry Location: 10

Waterfront Y/N: 1

Rooms & Units Description

Unit Number: 1002



Location Details

County Or Parish: Miami-Dade County

Fees & Taxes

Tax Annual Amount: 4925

Tax Year: 2023

Tax Legal Description: ONE MIAMI
EAST CONDO UNIT 1002 UNDIV 0.17%
INT IN COMMON ELEMENTS OFF REC
24030-4560 COC 24195-2351 01 2006
1

Association Fee: 787

Association Fee Frequency: Monthly

Association Fee Includes: Amenities, Common
Areas, Hot Water, Maintenance
Grounds, Parking, Pool(s), Trash, Water

Miscellaneous

Syndication Remarks: 1/1 unit in One Miami East with views of Biscayne Bay and the Brickell skyline. Enjoy 5-star amenities including lobby with 24 hrs security

**Year Built
Details:**
Resale

Virtual Tour URL: <https://www.propertypanorama.com/instaview/mia/A11491622>

Courtesy of

Office Name: Brickell Realty Group, LLC

