

# 690 SW 1ST CT PH11-15 MIAMI FL 33130

<https://www.cays.com>

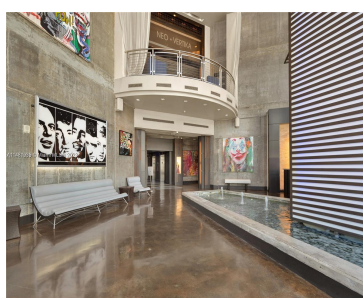

**\$689,000**

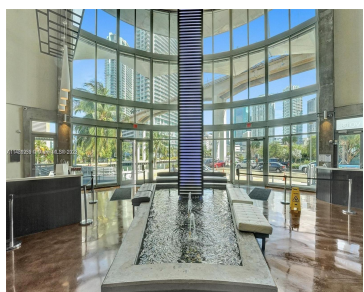
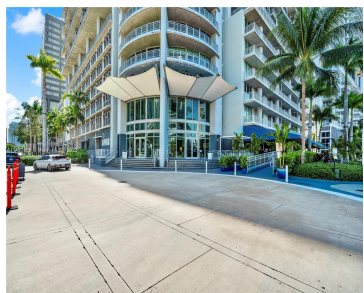

Beautiful 2 story Penthouse Loft in the heart of Brickell-Breathtaking bay & city views-Corner unit-20Ft to ceiling impact windows-Upgraded: porcelain 1st flr, wood in 2nd flr, ceiling refinished, bathrooms redone-Kitchen upgraded w/new SS appliances, granite-New A/C-All open plan NYC loft style-Master suite upstairs w/bonus office space-Large balcony-Inside laundry- Riverfront dining, infinity pool, Jacuzzi, sauna, full [...]

- 2 beds
- 2 baths
- Condominium
- Residential
- Active
- 1255 sq ft

## Basics

**Bathrooms Full:** 2

**Category:** Residential

**Status:** Active

**Bathrooms:** 2 baths

**Year built:** 2006

**Lot Size Units:** Square Feet

**Type:** Condominium

**Bedrooms:** 2 beds

**Area:** 1255 sq ft



---

## Property details

**Total Building Area:** 1255

**Direction Faces:** East

**Disclosures:** Flood Plain Disclosure

**Subdivision Name:** NEO VERTIKA CONDO

**Parcel Number:** 01-41-38-122-2180

**Possession:** Closing & Funding

**Property Condition:** Updated/Remodeled

---

## Property Features



**Exterior Features:** Balcony,Security/High Impact Doors

**Interior Features:** Bedroom on Main Level,First Floor Entry,High Ceilings,Living/Dining Room,Main Living Area Entry Level,Sitting Area in Primary,Split Bedrooms,Upper Level Primary,Bar

**Waterfront Features:** Ocean Access,River Front

**Window Features:** Blinds,Sliding,Impact Glass

**Pool Features:** Association

**Parking Features:** Assigned,Attached,Garage,Two or More Spaces,Valet

**Security Features:** Secured Garage/Parking,Key Card Entry,Lobby Secured,Smoke Detector(s)

**Appliances:** Dryer,Dishwasher,Electric Range,Electric Water Heater,Disposal,Ice Maker,Microwave,Refrigerator,Washer

**Architectural Style:** High Rise

**Association Amenities:** Basketball Court,Business Center,Clubhouse,Fitness Center,Library,Other,Playground,Pool,Sauna,Spa/Hot Tub,Trash,Vehicle Wash Area,Elevator(s)

**Construction Materials:** Block

**Cooling:** Central Air,Electric

**Cooling Y/N:** 1

**Covered Spaces:** 2

**Flooring:** Tile,Wood

**Furnished:** Negotiable

**Garage Spaces:** 2

**Garage Y/N:** 1

**Heating:** Central,Electric

**Heating Y/N:** 1

**Pets Allowed:** Conditional,Yes

**View:** Bay,City,Water

**View Y/N:** 1

**Entry Level:** 35

**Entry Location:** 35

**Patio and Porch Features:** Balcony,Open

**Property Attached Y/N:** 1

**Waterfront Y/N:** 1

**Attached Garage Y/N:** 1

**Stories:** 2

**Stories Total:** 35

**Utilities:** Cable Available

---

## Rooms & Units Description

**Unit Number:** PHII-15

**Number of Units in the Community:** 444

---

## Location Details



County Or Parish: Miami-Dade County

---

## Fees & Taxes

**Tax Annual Amount:** 5137

**Tax Year:** 2023

**Tax Legal Description:** NEO  
VERTIKA CONDO UNIT PH115 UNDIV  
0.003167568% INT IN COMMON  
ELEMENTS OFF REC 24605-3349  
COC 25049-1384 08 2006 1

**Association Fee:** 1177

**Association Fee Frequency:**  
Monthly

**Association Fee Includes:** Association  
Management,Amenities,Common Areas,Maintenance  
Structure,Pool(s),Recreation Facilities,Reserve  
Fund,Roof,Sewer,Security,Trash,Water

---

## Miscellaneous

**Public Survey Township:** 1

**Public  
Survey  
Section:** 38

**Syndication Remarks:** Beautiful 2story PH Loft NYC style-2Br/2Ba,1255 SF-  
Breathtaking bay & city views-20Ft flr to ceiling windows-Corner unit-Walk to  
Brickell City Center

**Year Built  
Details:**  
Resale

**Virtual Tour URL:** <https://www.propertypanorama.com/instaview/mia/A11481939>

---

## Courtesy of

**Office Name:** Coldwell Banker Realty

